

REV. NO.	REVISION NOTE	REVISER	DATE
V0	NEW DRAWING		2023/02/15

客户编码

XX-XXX

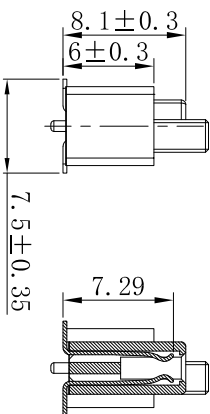
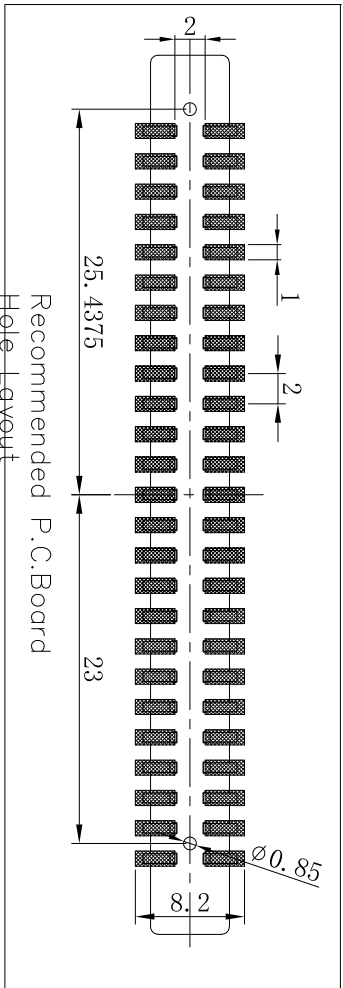
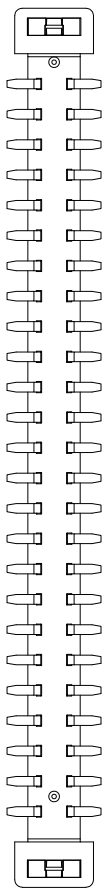
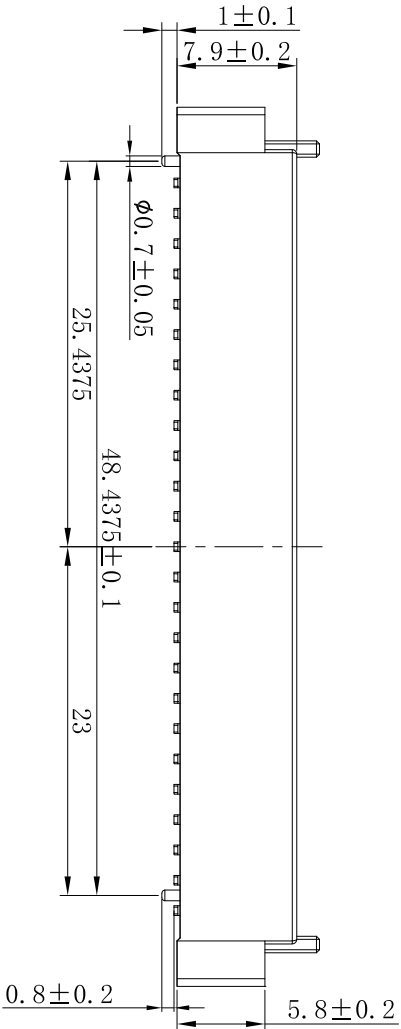
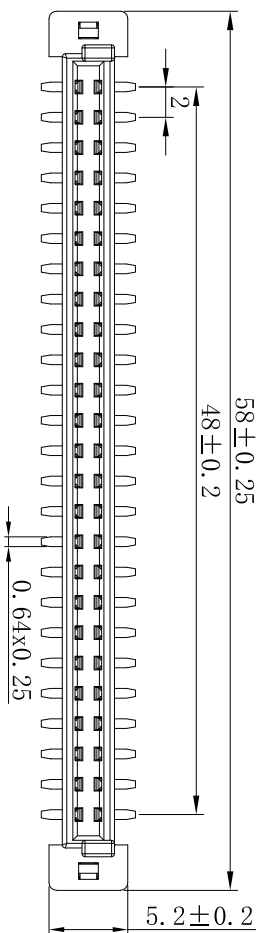

Construction:
 Insulator: Black Glass Filled Polyester
 Flammability Rating: UL 94V-0
 Contacts: Phosphor-Bronze of copper alloy
 Contacts plating: Selective gold on surface contact area
 Standard: JEDEC J-125
 与2.0板对板公座 高度 12±0.3

- 备注:
- 1、A= 2.0 X No. of Positions + 8
 - 2、B= 2.0 X No. of Contacts - 2.0
 - 3、胶壳用常规标准胶壳, 2xNo. of Contacts
 - 4、材质: PA6T 颜色: 黑色
 - 5、端子底层镀锡30~60 μm; 表面镀雾锡80 μm “接触区镀金1 μm”
 - 6、胶壳材质必须能过回流焊, 及回流焊过程中不脱落及融合



深圳市新世联电子有限公司
 TEL: +86 (755) 29912370 FAX: 29912372

Http://www.ciscomm.com		Title		2x25P 2.0板对板 母座 PA6T 镀金	
Tolerance Unless Otherwise Specified		Units		Scale	
.X ~ ±0.30	mm	2:1		REV NO.	
.XX ~ ±0.25		Date		V0	
.XXX ~ ±0.20		2023/02/15		XXXXX-XXXXX-XXX-XX	
Angle ~ ± 3°		Drawing By		Reviewed By	
		LiuYang		Date	
		2023/02/15		Approval By	
				Date	